

Control lever

arranged for clicking operation, technopolymer

MATERIAL

Glass-fibre reinforced polyamide based (PA) technopolymer, grey-black colour, matte finish.

BOSS CAP

- ECB.T: glass-fibre reinforced polyamide based (PA) technopolymer, in Elecolors colour, matte finish, press-fit assembly. Supplied, removable by a screwdriver.

Available also as accessory sold separately (see table).

STANDARD EXECUTION

Black-oxide steel boss, H7 reamed hole

FEATURES AND APPLICATIONS

Control levers ELCR. have a straight lever, parallel to the clamping surface. Particularly suitable when the lever turning angle is limited owing to lack of space.

ERGONOMY

Rotations are performed smoothly and powerfully thanks to the heavy-duty arm of the lever, while the enlarged end offers an effective grip.

MANOEUVRE ANGLE LIMITATION

A limited manoeuvre angle is possible by fitting stop pins in the rear guide slot.

ACCESSORIES ON REQUEST

- GN 184: axial retaining washer in black-oxide steel (see page ).
- MS.: ball and spring for clicking operation to be fitted into the two holes d3 drilled at 180° (see ball and spring on page ).
- ECB.T: glass-fibre reinforced polyamide based (PA) technopolymer boss cap, in Elecolors colour, matte finish, press-fit assembly (see table).

SPECIAL EXECUTIONS ON REQUEST

Levers with cross holes according to GN 110 (see page -).



ERGOSTYLE®

C1	C2	C3	C4	C5	C6	C17
RAL7021	RAL2004	RAL7035	RAL1021	RAL5024	RAL3000	RAL6017

ECB.T

Code	Description	Boss cap for
29553-*	ECB.T3-*	ELCR.118

\* Complete with colour index (C1, ..., C6).

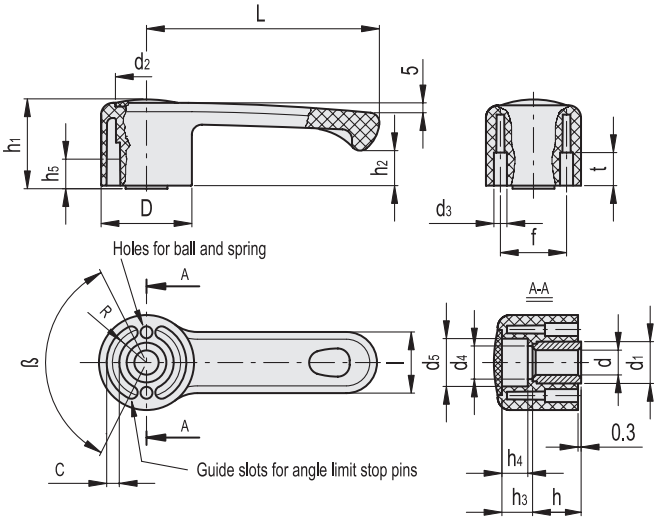

Assembly example  
by means of ball and spring  
for clicking operation

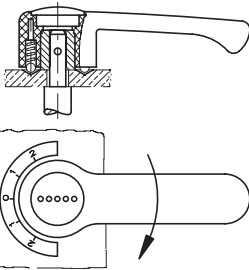

\* Complete with colour index, example: 212241-C2 ELCR.118 A-12-C2

C1	C2	C3	C4	C5	C6	C17
RAL7021	RAL2004	RAL7035	RAL1021	RAL5024	RAL3000	RAL6017

Code	Description	D	dh7	L	h	h1	h2	h3	h4	h5	d1	d2	d3*	d4	d5	l	R	t	c	β	f	△
212241-*	ELCR.118 A-12-*	46	12	118	22	44	18.5	19	17	10	22	31.5	6	17	25.5	29	17.5	15.5	6.5	125±1°	32	135